

PLAN

SCALE: 1/2" = 1'-0"

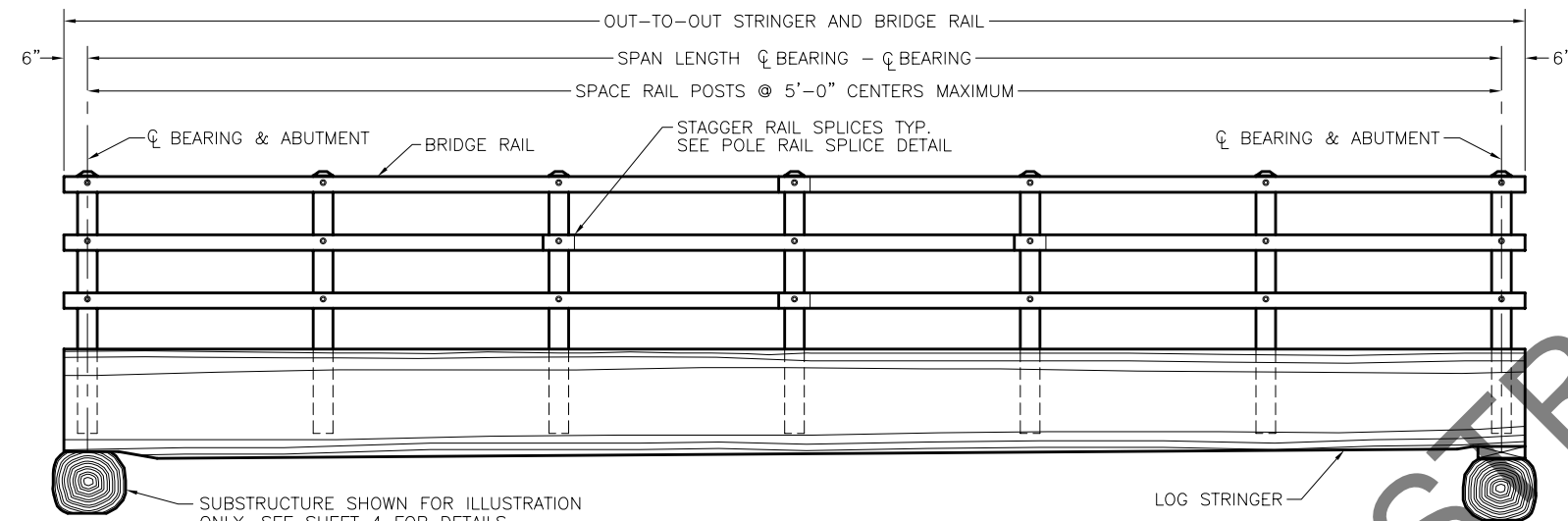

ELEVATION-INTERIOR FACE OF RAIL SUPERSTRUCTURE

RA820A2
SCALE: 1/2" = 1'-0"

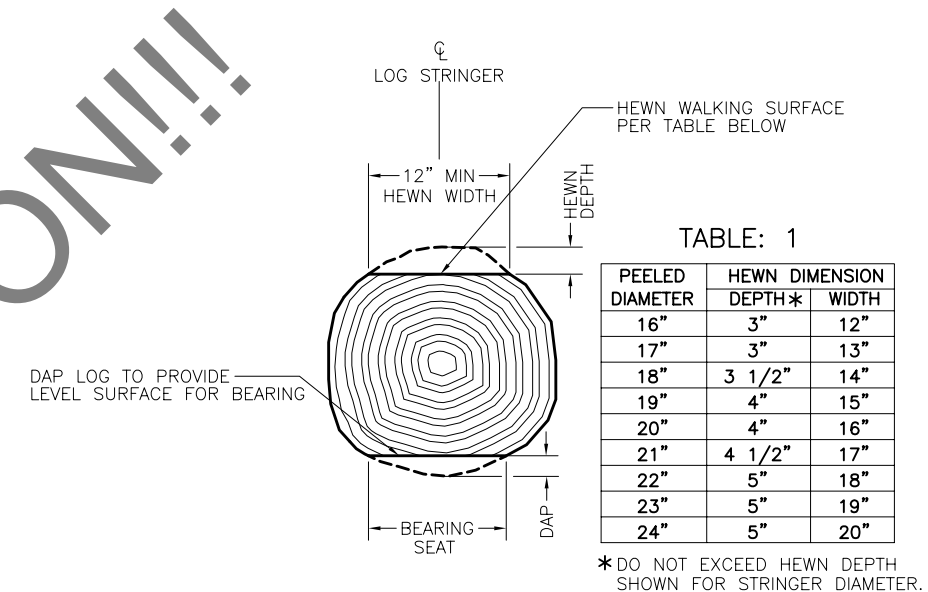

LOG STRINGER DAPPING

RS820C2
SCALE: 1" = 1'-0"
MAXIMUM DEPTH OF DAP AT BEARING SHALL NOT EXCEED 10% OF LOG DIAMETER OR 2"

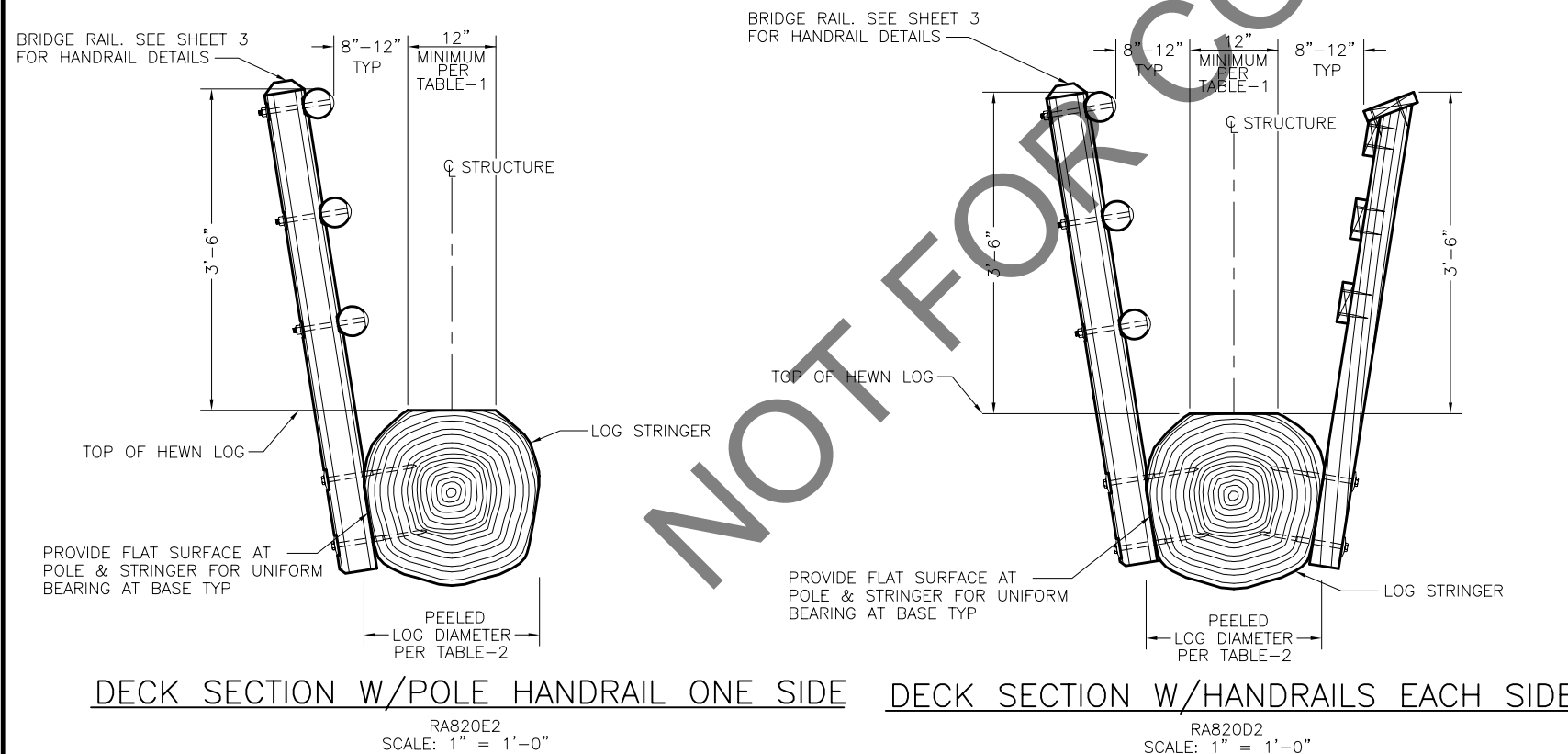

DECK SECTION W/POLE HANDRAIL ONE SIDE

RA820E2
SCALE: 1" = 1'-0"

DECK SECTION W/HANDRAILS EACH SIDE

RA820D2
SCALE: 1" = 1'-0"

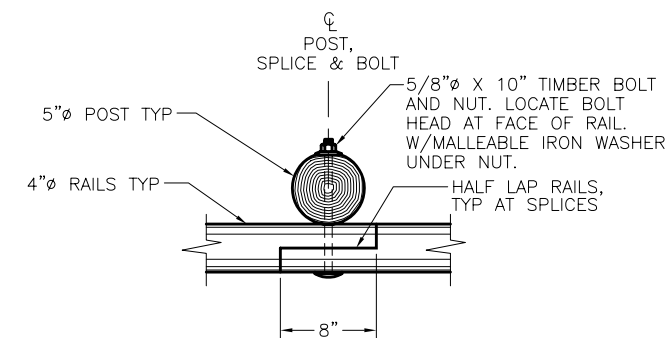

PLAN-POLE RAIL SPLICE DETAIL

RA820B2
SCALE: 1-1/2" = 1'-0"
NOTE: SPLICE RAILS AT POSTS. RAILS SHALL BE CONTINUOUS FOR A MINIMUM OF TWO POST SPACES. ALTERNATE RAIL SPLICES AT POSTS.

APPROVED:

FOREST ENGINEER

DATE

DWG NO.

-REDUCED-
DO NOT SCALE DRAWING

REV.	DESCRIPTION	APPROVED	DATE
△	REVISED TO R-6 STRUCTURES CAD STANDARDS	MOE	3/24/05

U.S. DEPARTMENT OF AGRICULTURE
FOREST SERVICE
THE PACIFIC NORTHWEST REGION (R-6)

SINGLE LOG STRINGER
10 FT - 45 FT LONG
TRAIL BRIDGE

Forest: _____ Loading: _____
 Bridge No.: _____ Length: _____
 Location: _____ Width: _____
 Designed: _____ Drawn: _____ Checked: _____
 Approved: _____/s/ MERVIN O. ERIKSSON Date: 03/01/2004
 REGIONAL BRIDGE ENGINEER